

SWIFTSPACE | MOBILE STORAGE

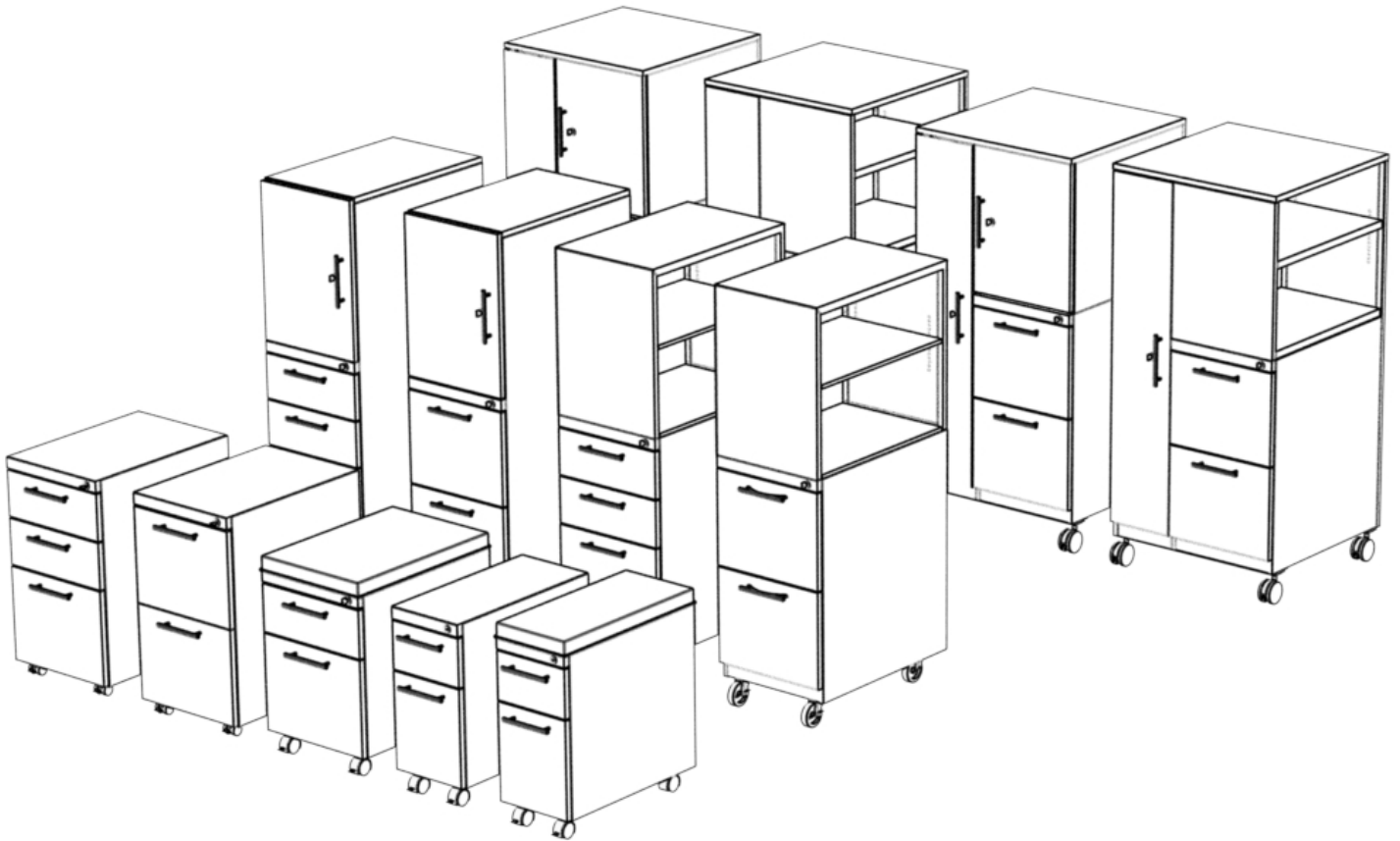

BENEFITS

Swiftspace is designed for flexibility, productivity, reducing costs, saving time and removing pain-points.

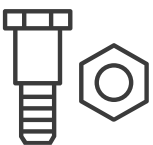

No loose parts to manage.



Minimal tools required.



No installers needed - it's DIY easy.



Reduce costs.



Installs in minutes, not hours



No punch list saves time.

Mobile Pedestal

Breadth of Offering

- Mobile Pedestals come in 15"W or 10"W
- Mobile Pedestals are available in 22"H, 24"H, or 27.5"H
- Mobile Pedestals are 22"D
- Drawer configurations include: Box/Box/File, File/File, or Box/File
- Box/File and Box/File 10"W are also available with a cushion top
 - Cushion fabric uses New Hempstead as standard
- Optional accessories include: Pencil Trays, Box Drawer Dividers, Hanging Bars for side to side filing
- Counterweight included
- Meet/exceeds ANSI-BIFMA standards
- All cabinets can be ordered keyed with one lock number per specified grouping or any combination of key numbers at no extra cost.

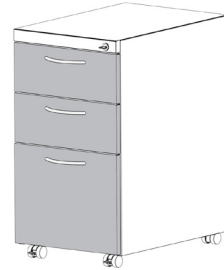

Box/Box/File



File/File

Construction

- Equipped with 4 black plastic casters - 2 locking, 2 non-locking
- Drawer slides are full extension, ball-bearing with quick disconnect and anti-rebound features
- Steel Gauges:
 - Wrappers: 22 gauge
 - Inner Framework (Vertical & Horizontal Supports): 20 gauge
 - Finished Tops for Freestanding & Mobile Peds: 18 gauge
 - Drawer Bodies: 22 gauge
 - Drawer Fronts: 20 gauge
- Box Drawer Body Interior Dimensions:
 - Side-to-Side: 11-15/16"
 - Bottom of Drawer Body to Top of Drawer Body Sides: 4-3/8"
 - Bottom of Drawer Body to Drawer Front Above (total vertical clear space): 5-1/2"
 - Front-to-Back: 18-11/16"
- File Drawer Body Interior Dimensions:
 - Side-to-Side: 11-15/16"
 - Bottom of Drawer Body to Top of Drawer Body Sides: 10-3/8"
 - Bottom of Drawer Body to Drawer Front Above (total vertical clear space): 11-1/2"
 - Front-to-Back: 18-11/16"

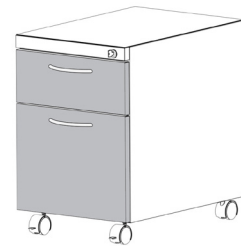

Box/File



**Box/File
w/ Cushion**



Box/File 10"W



**Box/File 10"W
w/ cushion**

Lateral File

Breadth of Offering

- Lateral Files come in 24"W, 30"W, 36"W, or 48"W
- Lateral Files are 21.5"H
- Lateral Files are 18"D
- Drawer configurations include: Open Bookcase, 1 Drawer & 1 Open Shelf, 2 Drawers (Box/File)
- Safety interlock system allows only one drawer to be opened at a time
- Single lock secures both drawers
- Counterweight included
- Meet/exceeds ANSI-BIFMA standards
- Two file bars in each drawer for side-to-side filing of letter, A4, or legal-sized file folders
- Optional accessories include: Hanging File Bars, for front to back filing
- Lateral file also available with cushion top
 - Cushion fabric uses New Hempstead as standard

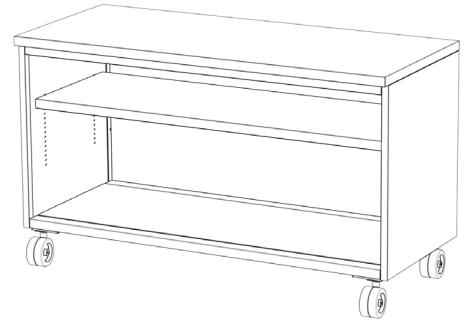

Construction

- Equipped with 4, 3" black plastic casters
- Steel Gauges:
 - Side Panels (including built-in vertical supports): 18 gauge
 - Back Panels: 20 gauge
 - Top Panels: 18 gauge
 - Top Panel Supports (Horizontal Hat Channels): 20 gauge
 - Bottom Panels: 18 gauge
 - Drawer Bodies: 20 gauge
 - Drawer Fronts: 20 gauge
- Drawer Body Interior Dimensions:
 - Front-to-Back: 16"
 - Bottom of Drawer Body to Top of Drawer Body Sides: 9-1/2"
 - Bottom of Drawer Body to Drawer Front Above (total vertical clear space): 11-1/8"
 - Side-to-Side for 30w Lateral Files: 26-7/16"
 - Side-to-Side for 36w Lateral Files: 32-7/16"
 - Side-to-Side for 42w Lateral Files: 38-7/16"
- Bookcases come with one height adjustable shelf

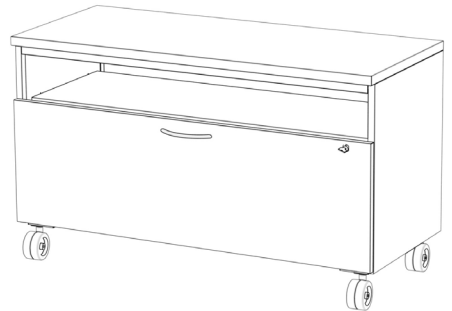

Towers

Breadth of Offering

- Towers are 52"H, 22"D, and 15"W
- Configurations include:
 - Bookcase upper with: Box/Box/File or File/File lower
 - Cabinet Upper with: Box/Box/File or File/File lower
- Cabinet configuration includes two locks, keyed alike
- Counterweight included
- Meet/exceeds ANSI-BIFMA standards
- All cabinets can be ordered keyed with one lock number per specified grouping or any combination of key numbers at no extra cost.
- Optional accessories include: Pencil Trays, Box Drawer Dividers, Hanging Bars for side to side filing, Magnetic shelf dividers,
- Shelves adjustable in 1/2" increments
- Concealed hinges with easy-adjustment capability

Construction

- Equipped with 4, 75mm black plastic casters - 2 locking, 2 non-locking
- Drawer slides are full extension, ball-bearing with quick disconnect and anti-rebound features
- Steel Gauges:
 - Top Panels: 18 gauge
 - Bottom Panels: 18 gauge
 - Shelves: 18 gauge
 - Ped Wrappers: 22 gauge
 - Ped Inner Framework (Vertical & Horizontal Supports): 20 gauge
 - Drawer Bodies: 22 gauge
 - Drawer Fronts: 20 gauge
 - Doors: 20 gauge
 - Door Supports (Vertical Hat Channels): 18 gauge
 - Side Panels for Bookcase and Cupboard Towers: 20 gauge
 - One-Piece Wrapper for Wardrobe Towers: 18 gauge

Box Drawer Body Interior Dimensions:

- Side-to-Side: 11-15/16"
- Bottom of Drawer Body to Top of Drawer Body Sides: 4-1/2"
- Bottom of Drawer Body to Drawer Front Above (total vertical clear space): 5-3/8"
- Front-to-Back: 18-11/16"

File Drawer Body Interior Dimensions:

- Side-to-Side: 11-15/16"
- Bottom of Drawer Body to Top of Drawer Body Sides: 10-3/8"
- Bottom of Drawer Body to Drawer Front Above (total vertical clear space): 11-1/2"
- Front-to-Back: 18-11/16"

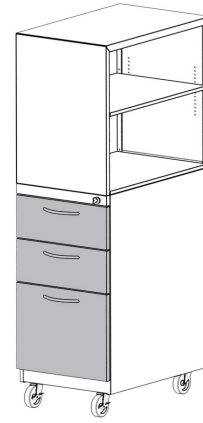

**Bookcase w/
Box/Box/File**

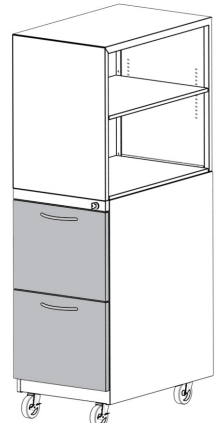

**Bookcase w/
File/File**

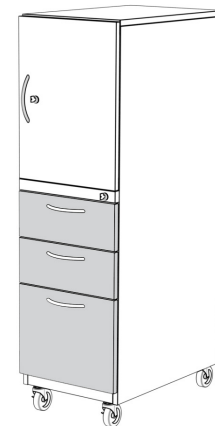

**Cabinet w/
Box/Box/File**

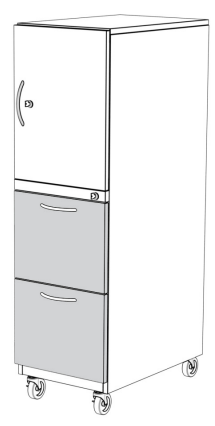

**Cabinet w/
File/File**

Wardrobes

Breadth of Offering

- Wardrobes are 52"H, 24"D, and 24"W
- Configurations include:
 - Bookcase upper with: Box/Box/File or File/File lower
 - Cabinet Upper with: Box/Box/File or File/File lower
 - Wardrobe can be either Left or Right configuration
- Cabinet configuration includes three locks, keyed alike
- Counterweight included
- Meet/exceeds ANSI-BIFMA standards
- All cabinets can be ordered keyed with one lock number per specified grouping or any combination of key numbers at no extra cost.
- Optional accessories include: Pencil Trays, Box Drawer Dividers, Hanging Bars for side to side filing, Magnetic shelf dividers,
- Shelves adjustable in 1/2" increments
- Concealed hinges with easy-adjustment capability

Construction

- Equipped with 4, 75mm black plastic casters - 2 locking, 2 non-locking
- Drawer slides are full extension, ball-bearing with quick disconnect and anti-rebound features
- Steel Gauges:
 - Top Panels: 18 gauge
 - Bottom Panels: 18 gauge
 - Shelves: 18 gauge
 - Ped Wrappers: 22 gauge
 - Ped Inner Framework (Vertical & Horizontal Supports): 20 gauge
 - Drawer Bodies: 22 gauge
 - Drawer Fronts: 20 gauge
 - Doors: 20 gauge
 - Door Supports (Vertical Hat Channels): 18 gauge
 - Side Panels for Bookcase and Cupboard Towers: 20 gauge
 - One-Piece Wrapper for Wardrobe Towers: 18 gauge

Box Drawer Body Interior Dimensions:

- Side-to-Side: 11-15/16"
- Bottom of Drawer Body to Top of Drawer Body Sides: 4-1/2"
- Bottom of Drawer Body to Drawer Front Above (total vertical clear space): 5-3/8"
- Front-to-Back: 18-11/16"
- File Drawer Body Interior Dimensions:
 - Side-to-Side: 11-15/16"
 - Bottom of Drawer Body to Top of Drawer Body Sides: 10-3/8"
 - Bottom of Drawer Body to Drawer Front Above (total vertical clear space): 11-1/2"
 - Front-to-Back: 18-11/16"

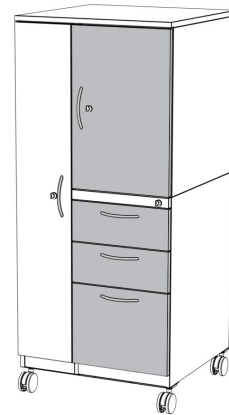

**Cabinet w/
Box/Box/File**



**Bookcase w/
Box/Box/File**

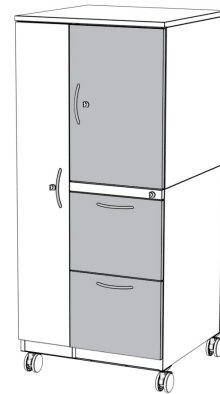

**Cabinet w/
File/File**

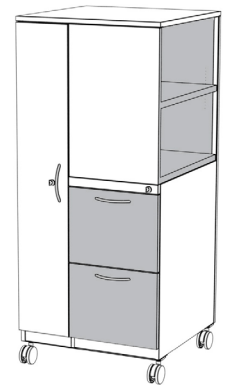

**Bookcase w/
File/File**